

The Rayher logo is a white circle containing the brand name "Rayher." in a black, cursive-style font.

JUST CREATE



CRAFTING IDEA

GB

Spring messengers.
Rooster and chicken as
plant picks.

WWW.RAYHER.COM



Used items:

46 839 505	Wood deco Rooster+Chickens, natural	2 pieces
87 102 685	Confetti, 2 cm ø, pastel	approx. 22 pieces
35 077 100	Allround Paint, acrylic, snow-white	some
35 077 270	Allround Paint, acrylic, pale pink	some
35 077 212	Allround Paint, acrylic, coral	some
35 077 308	Allround Paint, acrylic, lilac	some
62 028 00	Wooden spits, 30 cm, ø 3 mm	2 pieces

Additionally you need:

33 487 000 Glue Fix pen
Paintbrush, hot-melt glue



Instructions:

- 1 Paint the wooden deco Rooster & Chicken with acrylic paint. Allow to dry thoroughly.
- 2 Make small balls out of confetti and glue them on rooster and chicken using Glue Fix pen.
- 3 Glue the wooden spits on the rear side of the rooster and chicken using hot-melt glue.
- 4 You can now insert the plant pick into your plant pot.

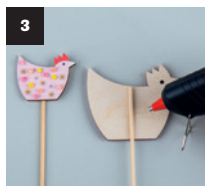
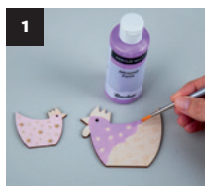

Rayher.

WWW.RAYHER.COM

More craft ideas and additional material information can be found on our website.

